

NP12-28(12V28AH)

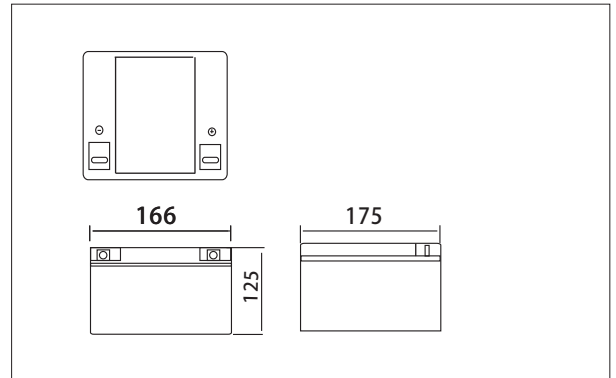

Outer dimensions (mm)



Specifications

| | | |
|-------------------------------|--------------|----------------------|
| Nominal Voltage | | 12V |
| Rated capacity (20 hour rate) | | 28Ah |
| Dimensions | Total Height | 125 mm (4.92 inches) |
| | Height | 125 mm (4.92 inches) |
| | Length | 175 mm (6.89 inches) |
| | Width | 166 mm (6.54 inches) |
| Weight Approx | | 8.6Kg (18.92lbs) |

Terminal Type (mm)

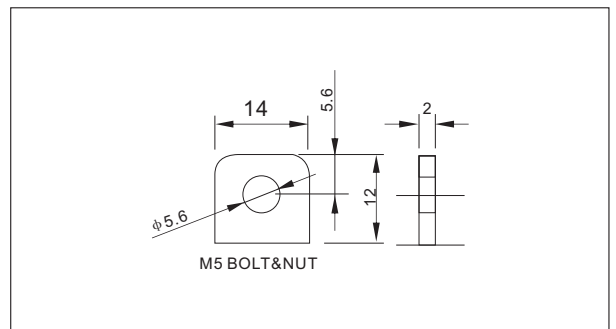

Characteristics

| | | |
|---|------------------------------------|--|
| Capacity 25°C(77°F) | 20 hour rate(1.40A) | 28.0AH |
| | 10 hour rate(2.60A) | 26.0AH |
| | 5 hour rate(4.76A) | 23.8AH |
| | 1 hour rate(16.8A) | 16.8AH |
| | 1.5 hour discharge to 10.5V | 11.2A |
| Internal Resistance | Full charged Battery at 25°C(77°F) | 7.5mΩ |
| Capacity affected by Temperature (20hour rate) | 40°C(104°F) | 102% |
| | 25°C(77°F) | 100% |
| | 0°C(32°F) | 85% |
| | -15°C(5°F) | 65% |
| Self-Discharge at 25°C(77°F) | Capacity after 3 month storage | 91% |
| | Capacity after 6 month storage | 82% |
| | Capacity after 12 month storage | 64% |
| Terminal | | T4 |
| Charge (constant Voltage) | Cycle | Initial Charging Current less than 11.2A Voltage 14.40-15.00V Time 14~16h |
| | Float | Voltage 13.50-13.80V |

Discharge Curves 25°C(77°F)

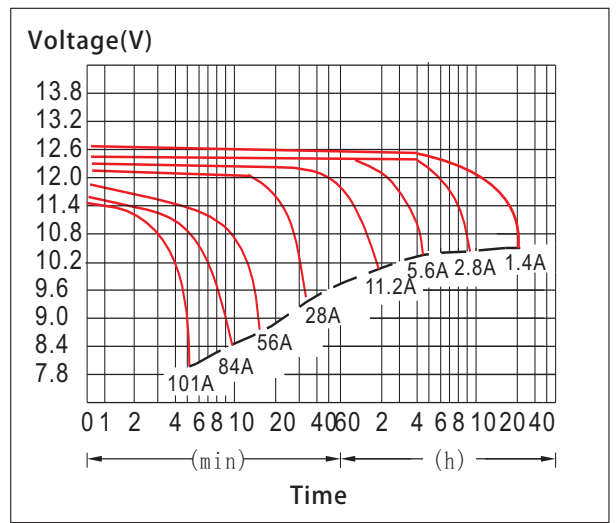

Constant Current(Amp) and Constant Power(Watt) Discharge Table at 25°C(77°F)

| Time | | 5min | 10min | 15min | 30min | 1h | 2h | 3h | 4h | 5h | 8h | 10h | 20h |
|--------|---|-------|-------|-------|-------|------|-------|------|------|------|------|------|------|
| 9.60V | A | 100.8 | 66.1 | 49.0 | 32.2 | 16.8 | 9.80 | 7.21 | 5.79 | 4.91 | 3.24 | 2.65 | 1.45 |
| | W | 1046 | 710 | 525 | 346 | 181 | 107.6 | 80.2 | 65.1 | 55.8 | 37.2 | 30.6 | 16.8 |
| 10.20V | A | 92.4 | 63.2 | 45.0 | 30.6 | 15.8 | 9.40 | 7.00 | 5.60 | 4.82 | 3.19 | 2.60 | 1.41 |
| | W | 992 | 707 | 504 | 343 | 178 | 108.4 | 81.1 | 65.1 | 56.2 | 37.3 | 30.6 | 16.6 |
| 10.50V | A | 84.1 | 59.1 | 42.0 | 29.6 | 15.3 | 9.22 | 6.88 | 5.32 | 4.76 | 3.15 | 2.58 | 1.40 |
| | W | 924 | 672 | 479 | 341 | 177 | 106.9 | 80.2 | 62.2 | 55.8 | 37.0 | 30.5 | 16.5 |
| 10.80V | A | 80.8 | 56.5 | 39.2 | 28.8 | 14.7 | 8.98 | 6.77 | 5.23 | 4.55 | 3.07 | 2.51 | 1.37 |
| | W | 907 | 651 | 452 | 334 | 172 | 105.2 | 79.8 | 61.7 | 53.8 | 36.4 | 29.8 | 16.3 |
| 11.10V | A | 74.8 | 53.2 | 36.4 | 28.0 | 14.2 | 8.75 | 6.42 | 5.13 | 4.35 | 2.99 | 2.45 | 1.33 |
| | W | 848 | 616 | 424 | 328 | 167 | 103.4 | 76.2 | 61.1 | 51.9 | 35.8 | 29.6 | 16.1 |